

DIMENSIONS & DATA CERTIFIED FOR:

Representative:

Order:

Customer:

Order:

Project:

Requirements:

By:

Date:

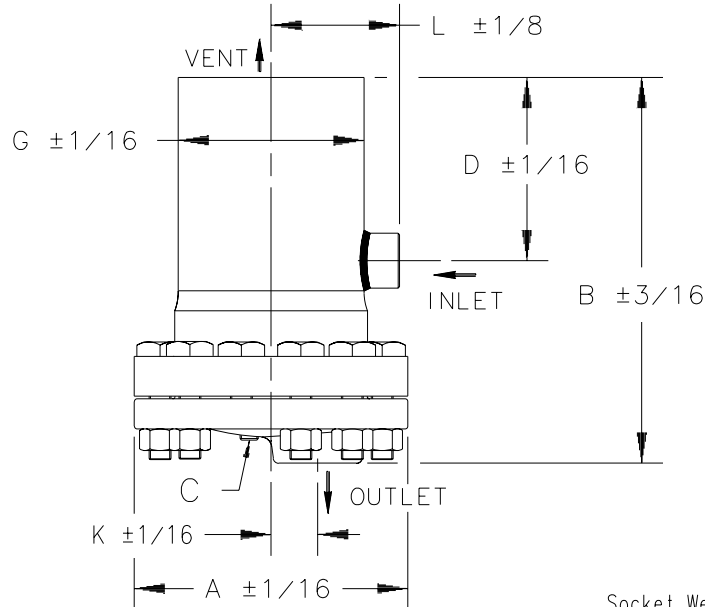

MODEL NO.	2313 HLS	2314 HLS	2315 HLS	2316 HLS	2413 HLS	2415 HLS	2416 HLS	
CONNECTION (SCR OR SW)	1/2", 3/4", 1"	3/4", 1", 1-1/4"	1", 1-1/4", 1-1/2"	1-1/2", 2"	1/2", 3/4", 1"	1", 1-1/4", 1-1/2"	1-1/2", 2"	
"A" (CAP DIA.) [mm]	8" [203]	8-5/8" [219]	9-3/4" [248]	11-7/8" [302]	8-5/8" [219]	10-3/4" [273]	12-1/2" [318]	
"B" (HEIGHT) [mm]	11-9/16" [294]	13-5/8" [346]	15-1/16" [383]	17-1/8" [435]	11-7/8" [302]	15" [381]	17-1/8" [435]	
"C" (NPT PLUG) [DN]	1/2" [15] OR 3/4" [20]	1/2" [15]			1/4" [8], 1/2" [15] OR 3/4" [20]	1/4" [8] OR 1/2" [15]	1/4" [8] OR 1/2" [15]	
"D" (VENT TO \varnothing INLET) [mm]	6-1/16" [154]	4" [102]	7-11/16" [195]	9" [229]	5-9/16" [141]	7-1/4" [184]	8-3/8" [213]	
"G" (BODY DIA.) [mm]	5-1/8" [130]	5-3/4" [146]	6-11/16" [170]	8-3/8" [213]	5-7/16" [138]	6-7/8" [175]	8-1/2" [216]	
"K" (\varnothing OF TRAP TO \varnothing OUTLET) [mm]	1-7/16" [37]		1-3/4" [44]	2-1/8" [54]	1-7/16" [37]	1-3/4" [44]	2-1/8" [54]	
"L" (\varnothing OF VENT TO INLET) [mm]	1/2"	3-1/2" [89]	—	—	—	3-5/8" [92]	—	
	3/4"	3-9/16" [90]	3-7/8" [98]	—	—	3-11/16" [94]	—	
	1"	3-7/8" [98]	4-3/16" [106]	4-5/8" [118]	—	4" [102]	4-3/4" [121]	
	1-1/4"	—	4-3/8" [111]	4-13/16" [122]	—	—	4-15/16" [125]	
	1-1/2"	—	—	4-15/16" [125]	5-15/16" [151]	—	5-1/16" [129]	5-7/8" [149]
	2"	—	—	—	6-5/32" [156]	—	—	6-1/8" [156]
WEIGHT [kgs]	46 lb [21]	72 lb [33]	98 lb [45]	160 lb [73]	69 lb [31]	130 lb [59]	210 lb [95]	
MAXIMUM ALLOWABLE PRESSURE (VESSEL DESIGN)	1000 psig at 100°F [68 bar at 38°C] 600 psig at 750°F [41 bar at 399°C]				1500 psig at 100°F [102 bar at 38°C] 900 psig at 850°F [61 bar at 454°C]	1800 psig at 100°F [122 bar at 38°C] 900 psig at 900°F [61 bar at 482°C]		

LIST OF MATERIALS

NAME OF PART	MATERIAL
BODY & CAP	2313-2316 ASTM A105 2413-2416 ASTM A182 GR. F22
LEVER MECHANISM & FLOAT	STAINLESS STEEL
VALVE & SEAT	HARDENED STAINLESS STEEL
GASKET	NON-ASBESTOS
BOLT	ASTM A193 GR. B7
NUT	ASTM A194 GR. 2H
PLUG, PIPE	ASTM A108 GR. 1215



Armstrong International, Inc.
Three Rivers Division
Three Rivers, MI 49093
(616) 273-1415 Fax (616) 278-6555

Product	CD No.	Date
DRAINER	1074	4/2/97
2313-2316 HLS 2413-2416 HLS 1/2"-2" (SCR & SW)		Rev. A